

NEW



Code: **G166**

Guide Pillar - Bolted Type

DIN 9825 / ISO 9182

* G166 is supplied with a screw and washer. GTH guide pillars are polished with surface polishing machine at final stage of production (after grinding).

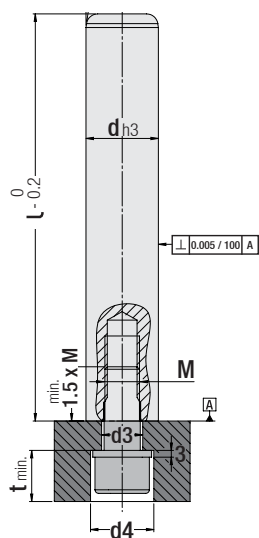

Hole pattern for pillar fastening:

Form - A



$d =$
 $\emptyset 15-16 / 19-20$
 $24-25 / 30-32 / 38-40$

Form - B

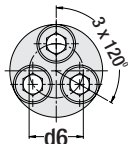

$d = \emptyset 48-50 / 60-63$

Form - C

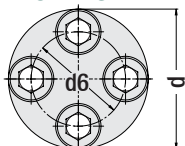

$d = \emptyset 80$

Note: Section (d), two different products are to avoid incorrect closing of die during mounting, three pieces main dimension and one piece auxiliary should be used ($d = \emptyset 16 - 19 - 24 - 32 - 38 - 48 - 60$ mm).

If extreme lateral forces are occurred at dies, in these cases, self-lubricating wear plates should be used with pillars.

d mm	d3 mm	d4 mm	d6 mm	t min.	M	L mm	Cap Screw	Form
15 16	9	17	-	12	M 8	90	M8 x 35	A
						100		
						112		
						125		
						140		
						160		
						180		
200								
19 20	11	20	-	14	M 10	100	M10 x 40	A
						112		
						125		
						140		
						160		
						180		
						200		
						224		
						250		
						280		
315								
24 25	14	22	-	16	M 12	100	M12 x 40	A
						112		
						125		
						140		
						160		
						180		
						200		
						224		
						250		
						280		
315								
30 32	18	28	-	20.5	M 16	125	M16 x 40	A
						140		
						160		
						180		
						200		
						224		
						250		
						280		
						315		
						355		

d mm	d3 mm	d4 mm	d6 mm	t min.	M	L mm	Cap Screw	Form
38 40	18	28	-	20.5	M 16	160	M16 x 40	A
						180		
						200		
						224		
						250		
						280		
						315		
355								
400								
450								
48 50	14	22	28	16	M 12	180	M12 x 50	B
						200		
						224		
						250		
						280		
						315		
						355		
						400		
						450		
						500		
60 63	18	28	34	20.5	M 16	250	M16 x 60	B
						280		
						315		
						355		
						400		
						450		
500								
80	18	28	54	20.5	M 16	280	M16 x 60	C
						315		
						355		
						400		
						450		
						600		

Order: G166. d x l

Material: $\emptyset 20 = 1.7131$
 > $\emptyset 20 = 1.1213$ (Cf53)
Hardness: 58 - 62 HRC

Operating Components: All sliding systems also can be used with ball cage bush.